

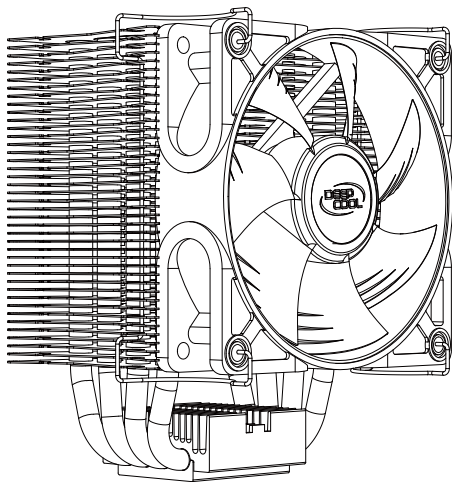

# INSTALLATION GUIDE

## 安装说明书

This installation guide is applicable for ICEEDGE 400XT and ICEEDGE 400FS.  
此说明书适用于九州风神冰凌400黑玉至尊版及冰凌400旗舰版。



ICEEDGE 400XT  
冰凌400黑玉至尊版

ICEEDGE 400FS  
冰凌400旗舰版

PRODUCT SCHEMATIC DRAWING  
产品示意图

### CAUTION:

1. All specifications subject to change without notice.
2. Under no condition shall Deepcool be liable for any indirect, incidental or consequential damages arising from any defect or error in this manual or product.
3. Please ask for professional help if you are not sure of safe installation.
4. Installation manual in other languages is available on our website: [www.deepcoolglobal.com](http://www.deepcoolglobal.com).

### 警告声明:

1. 本公司有权在未事先通知的情况下对本说明书进行修改，以便改进产品的稳定性、设计及功能。
2. 本说明书之描述内容不代表本公司之承诺，对于任何因安装或使用不当而造成直接、间接、有意、无意的损坏及隐患，本公司概不负责。
3. 在无法掌握操作方法前需请求专业人士帮助，严禁在未掌握操作要领的前提下使用本产品。
4. 若需对本公司产品了解更多信息，请浏览我们的网页：[www.deepcoolglobal.com](http://www.deepcoolglobal.com)

### COMPONENTS LIST 零部件说明

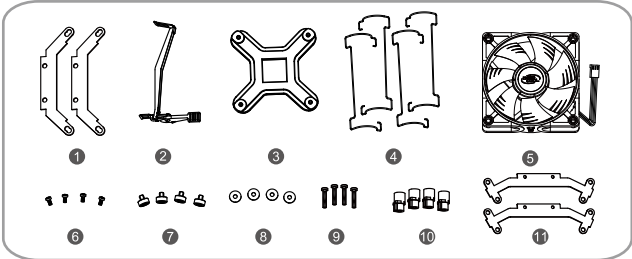

- |                                 |               |       |
|---------------------------------|---------------|-------|
| ① LGA1156/775 Retention Bracket | LGA1156/775扣具 | 2 pcs |
| ② AMD Spring Clip               | AMD扣具         | 1 pc  |
| ③ LGA775 Back Plate             | LGA775背板      | 1 pc  |
| ④ Fan Wire Clip                 | 钢丝扣具          | 4 pcs |
| ⑤ 9CM Fan                       | 9CM风扇         | 1 pc  |
| ⑥ Screw                         | 螺丝            | 4 pcs |
| ⑦ Rivet                         | 背铆钉           | 4 pcs |
| ⑧ Insulating Washer             | 绝缘胶垫          | 4 pcs |
| ⑨ Clip Screw                    | 固定螺丝          | 4 pcs |
| ⑩ Clip Nut                      | 塑胶扣           | 4 pcs |
| ⑪ LGA1366 Retention Bracket     | LGA1366扣具     | 2 pcs |

## INTEL LGA775 Installation 安装步骤

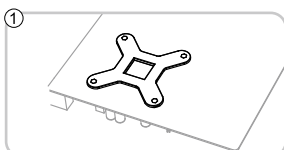

Place the LGA775 back plate on the back of the motherboard with the nuts into the LGA775 mounting holes.  
如图所示，将LGA775背板的铆钉穿过LGA775主板的相应孔位。

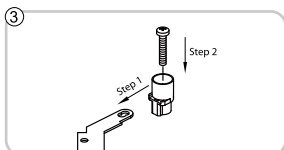

As illustrated, secure the clip nut into the LGA1156/775 retention bracket, and insert the clip screw through the nut and the bracket hole.  
按图示方向，将塑胶扣插入LGA1156/775扣具，用固定螺丝穿过塑胶扣的安装孔。

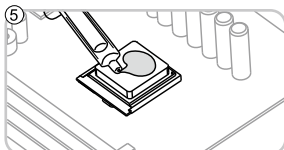

Evenly apply a thin layer of thermal grease onto the processor.  
将导热膏均匀涂在CPU表面。

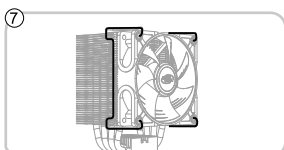

Attach the fan to the heatsink with wire clips.  
用钢丝扣具把风扇安装固定在散热片组的一侧。

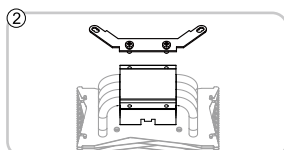

Attach the LGA1156/775 retention brackets onto the heatsink base by threading the screws.  
将螺丝穿过LGA1156/775扣具并对准散热片底部安装孔位，用十字螺丝刀拧紧螺丝，并检验确保扣具牢固，用同样方法安装好另一侧扣具。

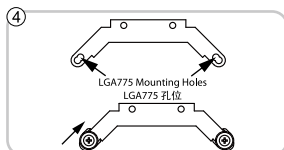

Push the plastic buckle with screws to the inner hole for LGA775 mounting.  
按照如图箭头所示方向，推动LGA1156/775扣具的塑胶扣至LGA775架构的孔位。

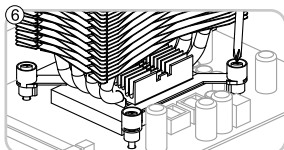

Place the heatsink onto the four rivets and fasten the screws within the plastic buckles on to the motherboard.  
将装好扣具的散热片组放在CPU上，注意底部与CPU表面完全接触，塑胶扣内的螺丝对准背板铆钉，用十字螺丝刀拧紧螺丝。

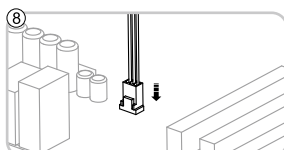

Finish the installation by connecting the fan cable to the motherboard.  
将风扇插头插在主板相应位置，确认无误后完成安装。

## INTEL LGA1156 Installation 安装步骤

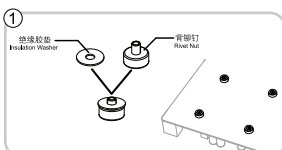

Peel off the films of insulating washers and stick the rivets onto the back of the motherboard.  
撕开绝缘胶垫一面脱纸，贴在背铆钉上面，撕开绝缘胶垫另一面脱纸，将背铆钉对准主板孔位放置，压紧。

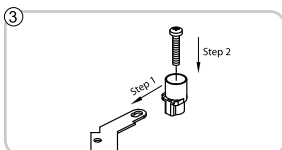

As illustrated, secure the clip nut into the LGA1156/775 retention bracket, and insert the clip screw through the nut and the bracket hole.  
按图示方向，将塑胶扣插入LGA1156/775扣具，用固定螺丝穿过塑胶扣的安装孔。

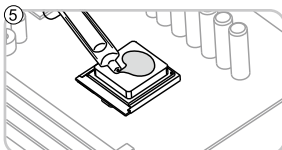

Evenly apply a thin layer of thermal grease onto the processor.  
将导热膏均匀涂在CPU表面。

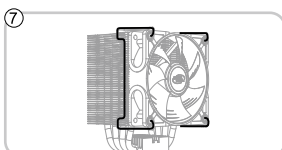

Attach the fan to the heatsink with wire clips.  
用钢丝扣具把风扇安装固定在散热片组的一侧。

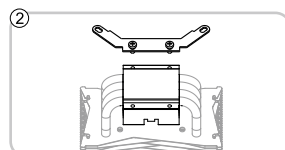

Attach the LGA1156/775 retention brackets onto the heatsink base by threading the screws.  
将螺丝穿过LGA1156/775扣具并对准散热片底部安装孔位，用十字螺丝刀拧紧螺丝，并检验确保扣具牢固，用同样方法安装好另一侧扣具。

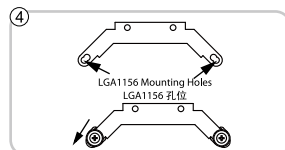

Push the plastic buckle with screws to the outer hole for LGA1156 mounting.  
按照如图箭头所示方向，推动LGA1156/775扣具的塑胶扣至LGA1156架构的孔位。

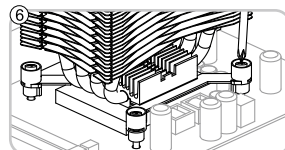

Place the heatsink onto the four rivets and fasten the screws within the plastic buckles on to the motherboard.  
将装好扣具的散热片组放在CPU上，注意底部与CPU表面完全接触，塑胶扣内的螺丝对准背板铆钉，用十字螺丝刀拧紧螺丝。

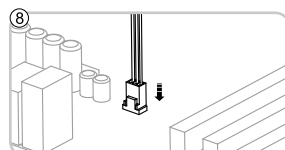

Finish the installation by connecting the fan cable to the motherboard.  
将风扇插头插在主板相应位置，确认无误后完成安装。

## INTEL LGA1366 Installation 安装步骤

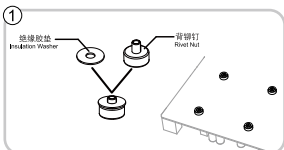

Peel off the films of insulating washers and stick the rivets onto the back of the motherboard.  
撕开绝缘胶垫一面脱纸，贴在背铆钉上面，撕开绝缘胶垫另一面脱纸，将背铆钉对准主板孔位放置，压紧。

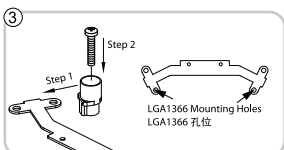

As illustrated, secure the clip nut into the LGA1366 retention bracket, and insert the clip screw through the nut and the bracket hole.  
按图示方向，将塑胶扣插入LGA1366扣具，用固定螺丝穿过塑胶扣的安装孔。

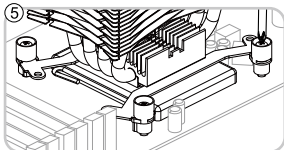

Place the heatsink onto the four rivets and fasten the screws within the plastic buckles on to the motherboard.  
将装好扣具的散热片组放在CPU上，注意底部与CPU表面完全接触，塑胶扣内的螺丝对准背板铆钉，用十字螺丝刀拧紧螺丝。

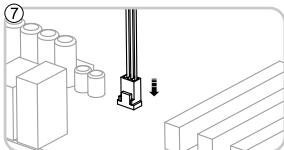

Finish the installation by connecting the fan cable to the motherboard.  
将风扇插头插在主板相应位置，确认无误后完成安装。

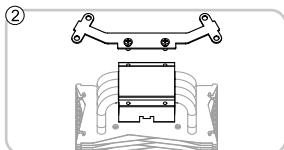

Attach the LGA1366 retention brackets onto the heatsink base by threading the screws.  
将螺丝穿过LGA1366扣具并对准散热片底部安装孔位，用十字螺丝刀拧紧螺丝，并检验确保扣具牢固，用同样方法安装好另一侧扣具。

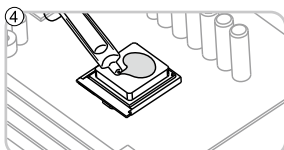

Evenly apply a thin layer of thermal grease onto the processor.  
将导热膏均匀涂在CPU表面。

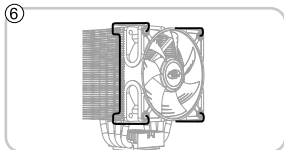

Attach the fan to the heatsink with wire clips.  
用钢丝扣具把风扇安装固定在散热片组的一侧。

## AMD AM3/AM2+/AM2/K8 Installation 安装步骤

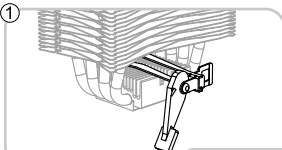

Insert the spring clip across the heatsink base as illustrated.  
按图示将AMD扣具横向穿过散热片组，再按箭头方向旋转扣具至垂直位置。

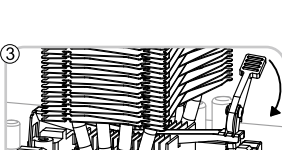

Put the heatsink onto the processor, attach the spring clip to the retention frame tab, turn the cam-lock to fasten the clip and secure the heatsink.  
将散热片组放在CPU上，注意底部与CPU表面完全接触，然后按小图方法用AMD扣具勾住AM2塑胶架的两端，再按图示箭头方向转动扣具手柄，扣紧扣具。



Finish the installation by connecting the fan cable to the motherboard.  
将风扇插头插在主板相应位置，确认无误后完成安装。

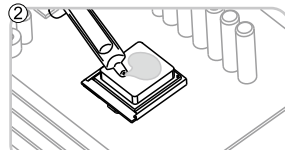

Evenly apply a thin layer of thermal grease onto the processor.  
将导热膏均匀涂在CPU表面。

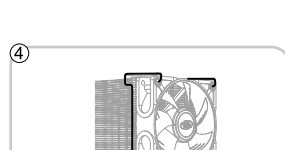

Attach the fan to the heatsink with wire clips.  
用钢丝扣具把风扇安装固定在散热片组的一侧。