

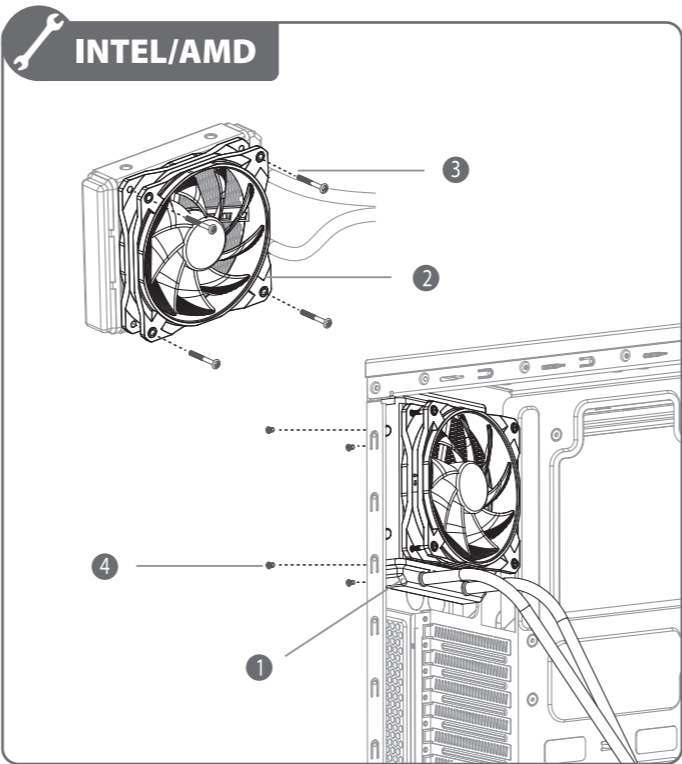

MAELSTROM
User manual

1 Heatsink set	1 pc	2 120mm Fan	1 pc	3 Screw(1)	4 pcs	4 Screw(2)	4 pcs	5 Back Plate	1 pc
6 Screw Bolt	4 pcs	7 Insulative cushion	4 pcs	8 Screw(3)	4 pcs	9 Mounting Bracket(intel)	2 pcs	10 Mounting Bracket(AMD)	2 pcs
11 Double-screw Bolt (For LGA2011 only)	4 pcs	12 Nut	4 pcs	13 Metal Logo Sticker	1 pc	Well note: Please keep cooling block at the direction which has no interference with the neighboring parts.			



INTEL
LGA1366
LGA1156
LGA1155
LGA1150
Installation

AMD
FM2+
FM2
FM1
AM3+
AM3
AM2+
AM2
Installation

INTEL
LGA2011
Installation

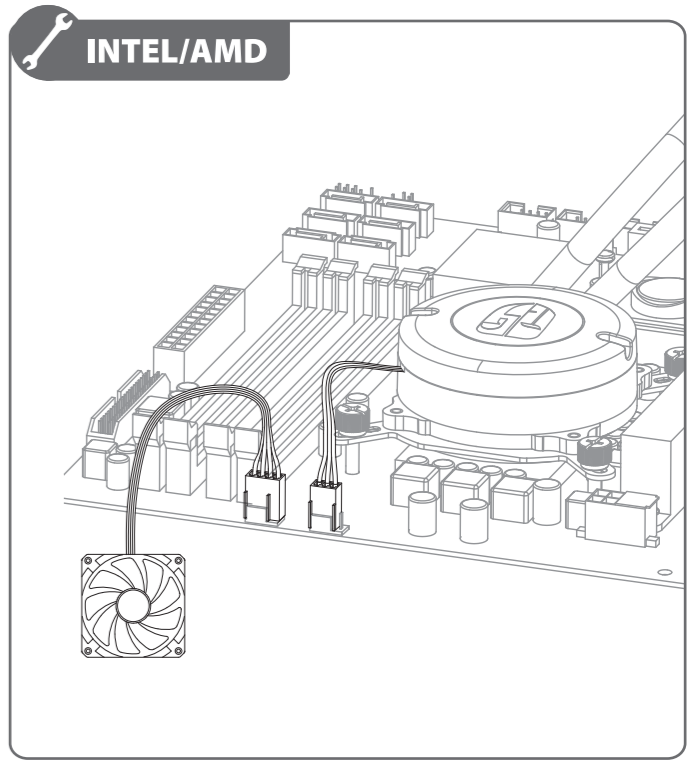

www.gamersstorm.cn